

## Parte esterna termostatico doccia incasso 2 uscite SMOOTH X32\_X3018100

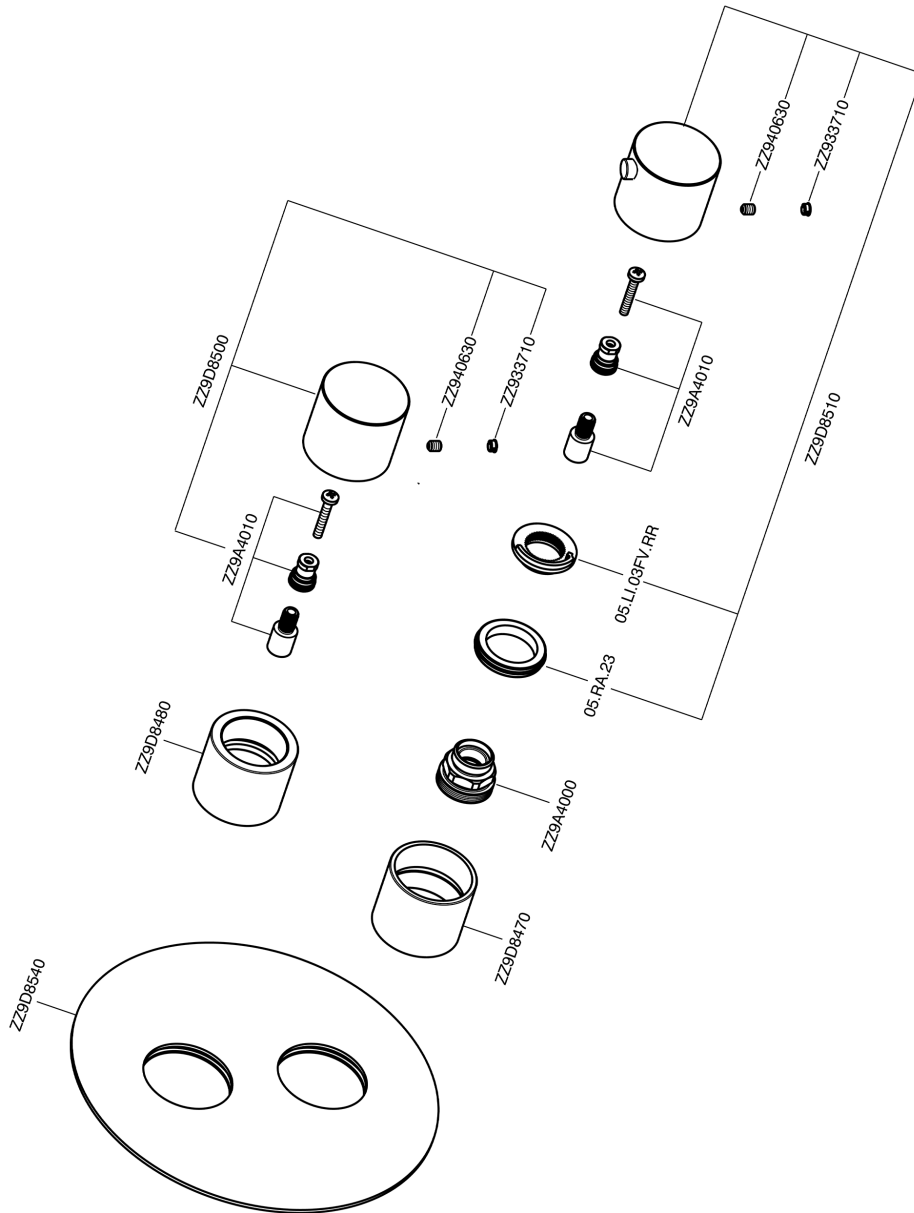

X3018100

<https://www.cisal.it/parte-esterna-termostatico-doccia-incasso-2-uscite-smooth-x32-x3018100>

## Parte incasso termostatico doccia 2 uscite INCASSO\_ZA018101

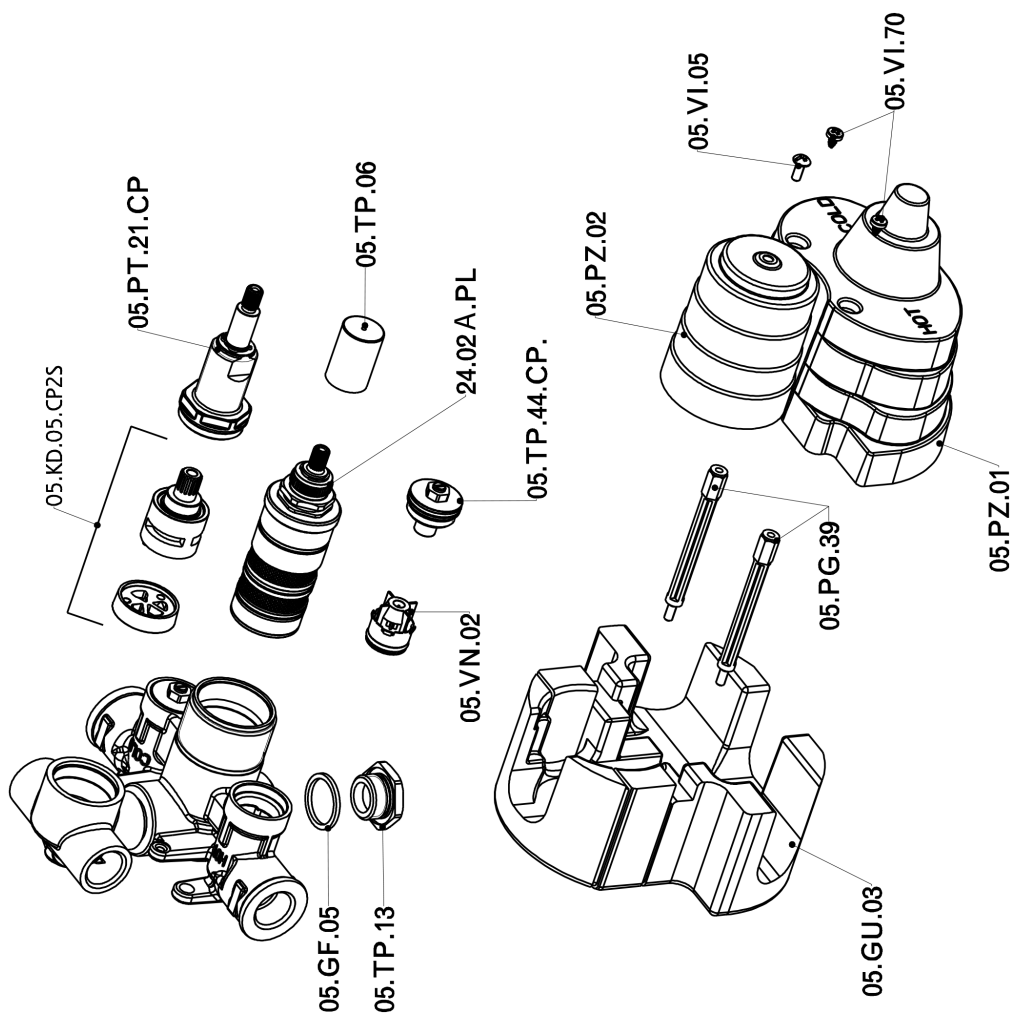

ZA018101

<https://www.cisal.it/parte-incasso-termostatico-doccia-2-uscite-incasso-za018101>

2026-05-03